

4611110033080

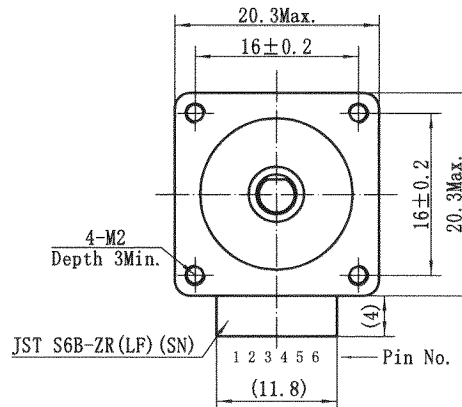

接线图  
Wiring Diagram

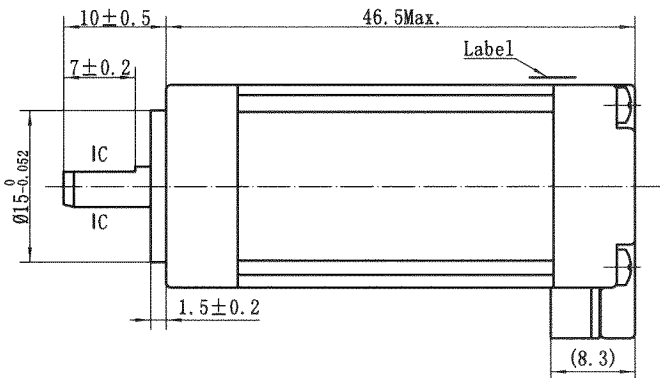
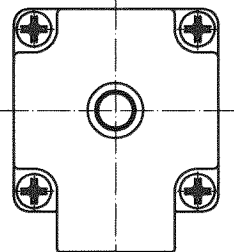
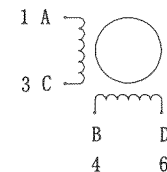

励磁顺序 vs. 旋转方向  
Exciting Sequence vs. Direction of Rotation

| STEP | A | B | C | D | CW |
|------|---|---|---|---|----|
| 1    | + | + | - | - | ↑  |
| 2    | - | + | + | - |    |
| 3    | - | - | + | + |    |
| 4    | + | - | - | + |    |

从安装面看为顺时针方向  
Clockwise view from mounting side

规格 Specifications

|                           |   |
|---------------------------|---|
| 1. 相数 Number of Phase     | 2   |
| 2. 步距角 Step Angle         | 1.8°                                      |
| 3. 额定电压 Rated Voltage     | 6.56V DC                                  |
| 4. 额定电流 Rated Current     | 0.40Amp                                   |
| 5. 保持力矩 Holding Torque    | 0.057Nm Typ. (Two phase on/rated current) |
| 6. 相电阻 Phase Resistance   | 16.4ohm±10% (20° C)                       |
| 7. 相电感 Phase Inductance   | 12mH±20% (1kHz 1V rms)                    |
| 8. 转子惯量 Rotor Inertia     | 4.2gcm <sup>2</sup>                       |
| 9. 电机重量 Motor Weight      | 0.08kg                                    |
| 10. 绝缘等级 Insulation Class | B(130° C)                                 |

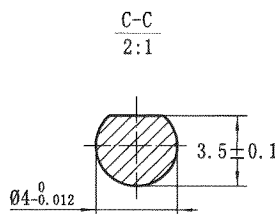

铭牌 Label Detail

MOONS' STEPPING MOTOR  
TYPE MS08HY5P4040  
XXXXXXXX YY/MM/DD

Work Order 加工单号  
Date Format 日期格式

保 密

Unit: mm  
第一角画法  
FIRST ANGLE METHOD  
未注线性与角度尺寸公差  
Tolerances for linear and angular dimensions without individual tolerance indications  
GB/T 1804-m eqv ISO 2768-1: m  
未注形状与位置尺寸公差  
Geometrical tolerance for features without individual tolerance indications  
GB/T 1184-K eqv ISO 2768-2: K

|               |                  |            |
|---------------|------------------|------------|
| 批准 Approve    | <i>Signature</i> | 5.21       |
| 标准化 Standard  | <i>Signature</i> | 5.21       |
| 工艺 Technology | <i>Signature</i> | 5.21       |
| 审核 Check      | <i>Signature</i> | 5.21       |
| 设计 Design     | 艾志威              | 2019.05.14 |
| NAMES         | SIGNATURE        | DATE       |

|   |                       |
|---|-----------------------|
| <b>MOONS'</b>   | Hybrid Stepping Motor |
| Shanghai Moons' Electric Co., Ltd.  |                       |
| This document is released for information only. Its reproduction in whole or in part or its dissemination to third parties is prohibited. |                       |
| All trademarks and registered trademarks appearing on this document are the property of their respective owners.                          |                       |
| Type: MS08HY5P4040  | Rev. A                |
| SCALE 2:1   | Sheet 1 of 1          |

| REV. | 版本记录 REVISION RECORD   | DATE       |
|------|------------------------|------------|
| A    | 原始版本 Original revision | 2019.05.14 |